

de	Montageanleitung	Aufbausatz
en	Mounting instructions	Mounting kit
fr	Instructions de montage	Kit de montage
sv	Monteringsinstruktion	Monteringssats
nl	Montage-aanwijzing	Opbouwset
it	Istruzioni di montaggio	Accoppiamento
fi	Asennusohje	Asennussarja
es	Instrucciones de montaje	Equipo de montaje
da	Monteringsvejledning	Montasjesats
pl	Instrukcja montażu	Zestaw montażowy
cz	Montážní návod	Montážní sada
hu	Szerelési útmutató	Összeépítő készlet
el	Οδηγίες εγκατάστασης	Μοχλισμός εγκατάστασης
zh	安裝指導	安裝套件

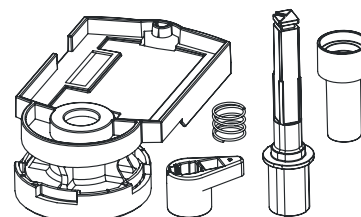

ASK77.4

VA../VB..61.., DN 15...25 + GQD..1A

VA../VB..60.., DN 15...25 + GQD..1A

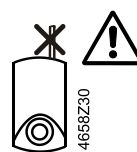
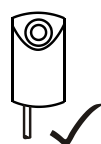
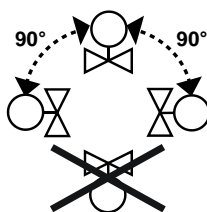
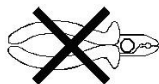

ASK77.4 + GQD..1A

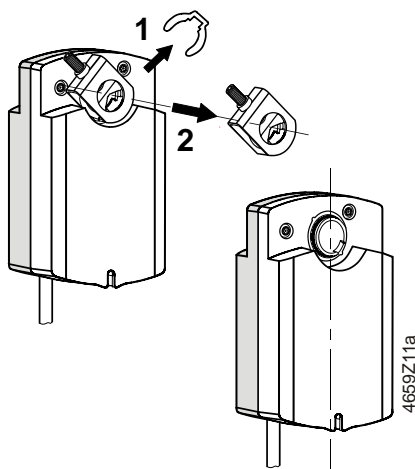

1

ASK77.4 + GQD..1A + V..61.. ➡ 2 ... 6.3

ASK77.4 + GQD..1A + V..60.. ➡ 7 ... 9.3

2

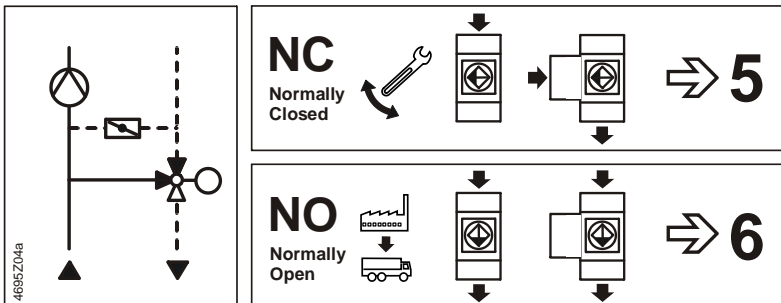
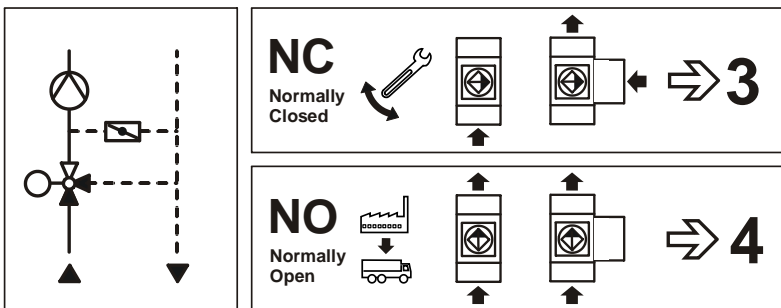

3

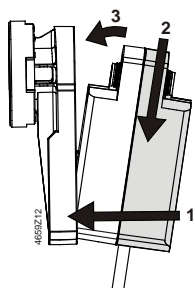

3.1

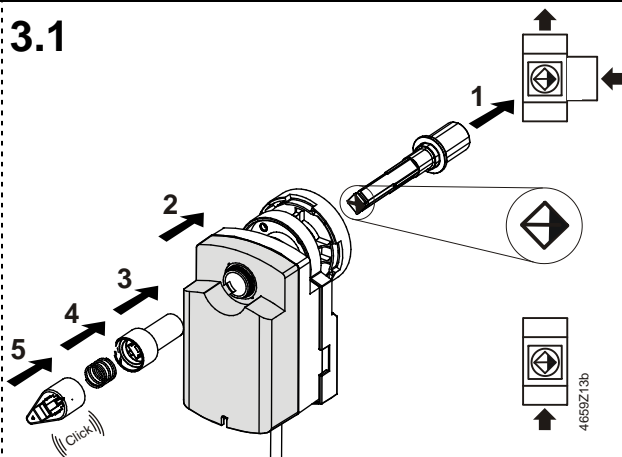

3.2

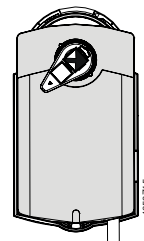

3.3

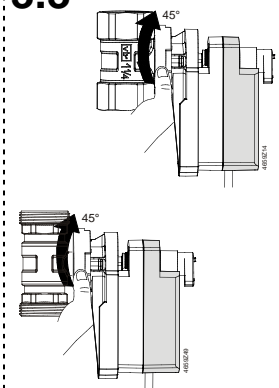

4

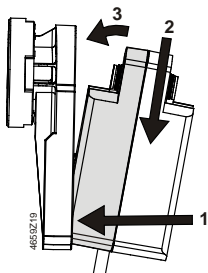

4.1

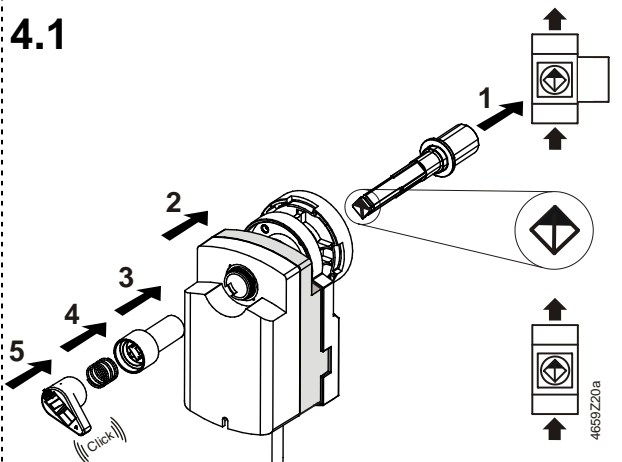

4.2

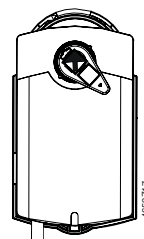

4.3

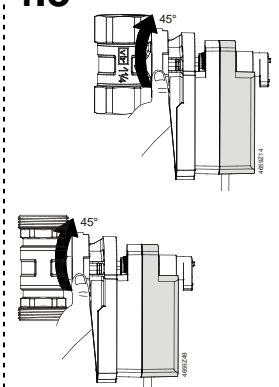

5

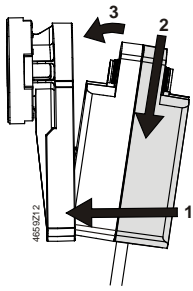

5.1

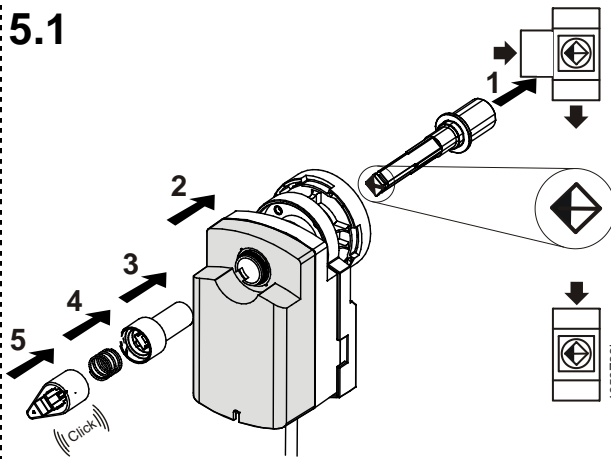

5.2

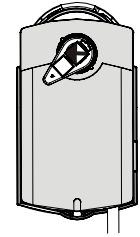

5.3

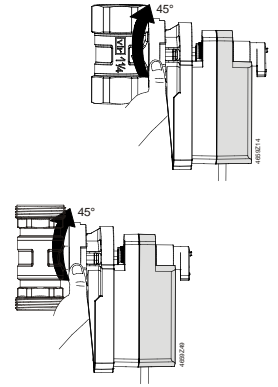

s

6

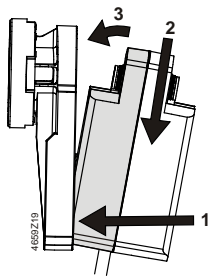

6.1

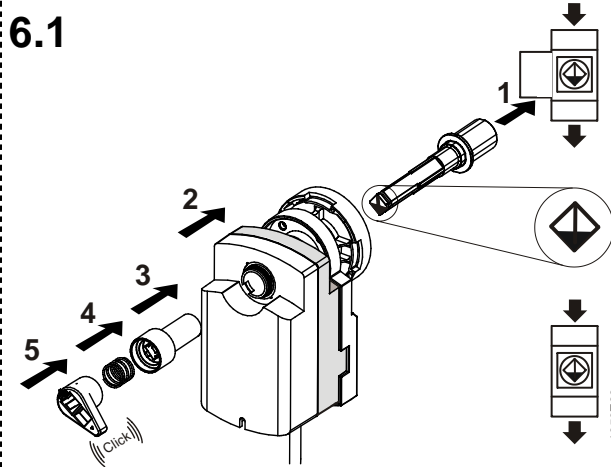



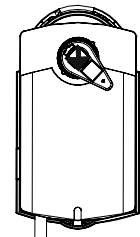



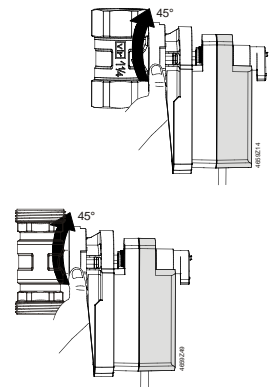

6.2

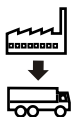

6.3

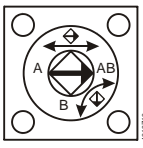
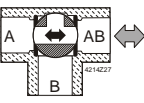

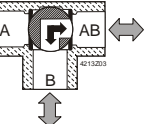
7

			GQD..1A + V..60..
VA..60..	—		 8
VB..60..T			 8
VBI60..L			 9

4659Z47b

8

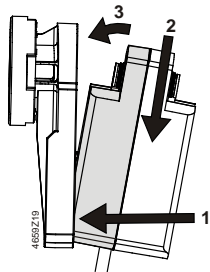

8.1

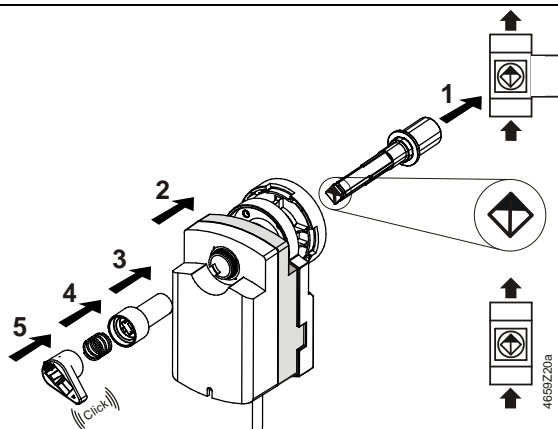

8.2

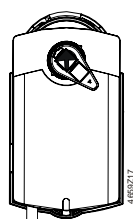

8.3

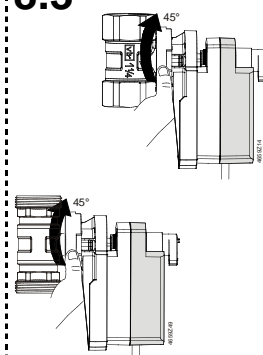

9

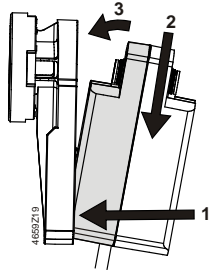

9.1

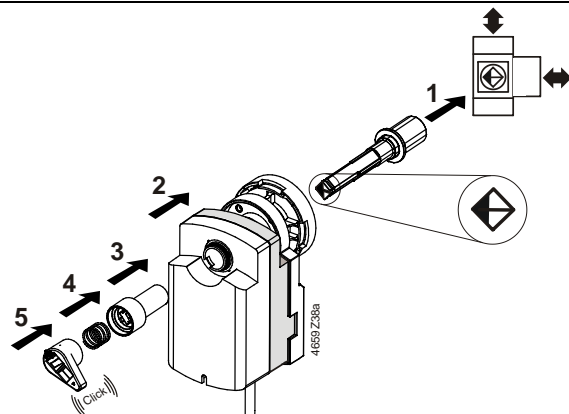

9.2

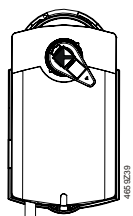

9.3

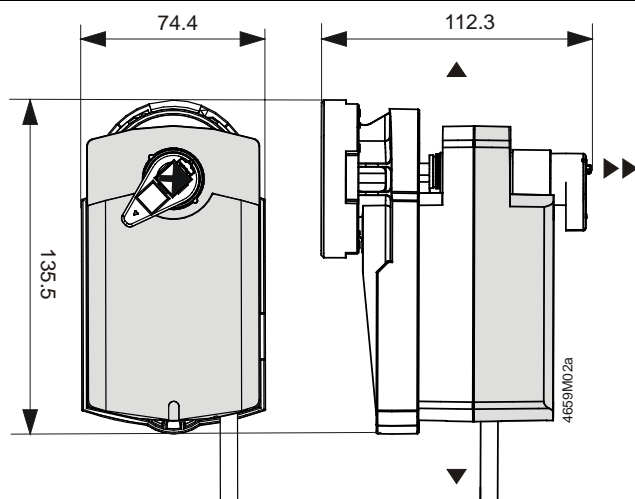
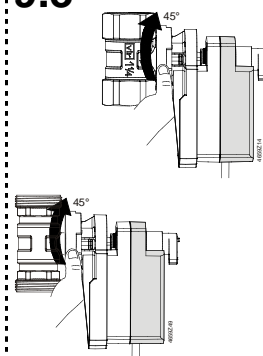

Minimum clearance from ceiling or wall for mounting, connection, operation, maintenance etc.

▶ = > 100 mm

▶▶ = > 200 mm

Masse in mm

Dimensions in mm

Dimensions en mm

Mått i mm

Afmetingen in mm

Dimensioni in mm

Mitat mm

Dimensiones en mm

Mål i mm

尺寸单位 mm